

PH0698148

UNITED STATES DEPARTMENT OF THE INTERIOR
NATIONAL PARK SERVICE

FOR NPS USE ONLY
RECEIVED FEB 26 1979
DATE ENTERED APR 24 1979

**NATIONAL REGISTER OF HISTORIC PLACES
INVENTORY -- NOMINATION FORM**

SEE INSTRUCTIONS IN *HOW TO COMPLETE NATIONAL REGISTER FORMS*
TYPE ALL ENTRIES -- COMPLETE APPLICABLE SECTIONS

1 NAME

HISTORIC Oakhurst (Matthews House)

AND/OR COMMON Budd Matthews House

2 LOCATION

STREET & NUMBER 2723 Main Street

CITY, TOWN Newberry VICINITY OF CONGRESSIONAL DISTRICT 3

STATE South Carolina CODE 045 COUNTY Newberry CODE 071

3 CLASSIFICATION

CATEGORY	OWNERSHIP	STATUS	PRESENT USE
<input type="checkbox"/> DISTRICT	<input type="checkbox"/> PUBLIC	<input checked="" type="checkbox"/> OCCUPIED	<input type="checkbox"/> AGRICULTURE
<input checked="" type="checkbox"/> BUILDING(S)	<input checked="" type="checkbox"/> PRIVATE	<input type="checkbox"/> UNOCCUPIED	<input type="checkbox"/> MUSEUM
<input type="checkbox"/> STRUCTURE	<input type="checkbox"/> BOTH	<input type="checkbox"/> WORK IN PROGRESS	<input type="checkbox"/> COMMERCIAL
<input type="checkbox"/> SITE	PUBLIC ACQUISITION	ACCESSIBLE	<input type="checkbox"/> EDUCATIONAL
<input type="checkbox"/> OBJECT	<input type="checkbox"/> IN PROCESS	<input type="checkbox"/> YES: RESTRICTED	<input type="checkbox"/> ENTERTAINMENT
	<input type="checkbox"/> BEING CONSIDERED	<input type="checkbox"/> YES: UNRESTRICTED	<input type="checkbox"/> GOVERNMENT
		<input type="checkbox"/> NO	<input type="checkbox"/> INDUSTRIAL
			<input type="checkbox"/> MILITARY
			<input checked="" type="checkbox"/> PRIVATE RESIDENCE
			<input type="checkbox"/> PARK
			<input type="checkbox"/> RELIGIOUS
			<input type="checkbox"/> SCIENTIFIC
			<input type="checkbox"/> TRANSPORTATION
			<input type="checkbox"/> OTHER:

4 OWNER OF PROPERTY

NAME Mrs. W. E. Matthews

STREET & NUMBER 2723 Main Street

CITY, TOWN Newberry VICINITY OF STATE South Carolina

5 LOCATION OF LEGAL DESCRIPTION

COURTHOUSE, REGISTRY OF DEEDS, ETC. Newberry County Courthouse

STREET & NUMBER 1226 College Street

CITY, TOWN Newberry STATE South Carolina

6 REPRESENTATION IN EXISTING SURVEYS

TITLE Inventory of Historic Places in South Carolina

DATE 1979 FEDERAL STATE COUNTY LOCAL

DEPOSITORY FOR SURVEY RECORDS South Carolina Department of Archives & History

CITY, TOWN Columbia STATE South Carolina

7 DESCRIPTION

CONDITION		CHECK ONE	CHECK ONE
<input checked="" type="checkbox"/> EXCELLENT	<input type="checkbox"/> DETERIORATED	<input type="checkbox"/> UNALTERED	<input type="checkbox"/> ORIGINAL SITE
<input type="checkbox"/> GOOD	<input type="checkbox"/> RUINS	<input checked="" type="checkbox"/> ALTERED (minor)	<input type="checkbox"/> MOVED DATE _____
<input type="checkbox"/> FAIR	<input type="checkbox"/> UNEXPOSED		

DESCRIBE THE PRESENT AND ORIGINAL (IF KNOWN) PHYSICAL APPEARANCE

Oakhurst is a two story brick private residence built circa 1893 to 1895 by Budd Cade Matthews and Sarah Crotwell Matthews on the site of an earlier dwelling. Designed by the firm of Niernsee and La Motte of Columbia, South Carolina, the house reflects both the Queen Anne and Italianate influences. Oakhurst is also notable for its extant collection of original dependencies, which include a brick privy, brick milk house, frame stable, combination wood/hen house, and well.

Exterior: The two story brick structure is set on low brick piers and has walls 18" thick; according to family tradition, the brick is said to have come from the Matthews brick yard. Asymmetrical in form, the house features numerous elements which are exemplary of the Queen Anne style. These include an encircling veranda; a three story turret with shingled tent roof; tall, narrow panelled chimneys; roof cresting; and several steep gables. The Italianate mode is evidenced by round arches, two-light sash, the low hipped roof with heavy overhanging eaves and by the horizontal string courses which continue unbroken around the turret. A one story balustraded veranda extends from the turret at the right corner of the front facade across both the front and left facades; it is supported by Italianate paired colonettes with panelled piers beneath. Fenestration is irregular, but is arranged in bays by stories, extending uninterrupted around the turret. Windows are largely trabeated and 1/1, aside from the arched entryway of the front facade. The turret features different windows in each of the exposed hexagonal planes.

The main feature of the front (south) facade is the double central pavillion, with a monumental arched entryway on the lower story and a pedimented upper story pierced by arched double windows. Of significance in the left (west) facade is the porte cochere extending outward from the central bay of the veranda. The porte cochere has a balustraded roof line and is crowned on the second story eave by a pedimented gable and paired brackets. The important feature of the right (east) facade is the two story pavillion. It consists of pilasters flanking the lower story windows, above which there is a pedimented balcony, featuring the colonette and balustrade motif of the veranda. Both the pediment and the flared balcony have shingled facing.

The original cream and red paint for Oakhurst, as specified in the architects' original plans, has been maintained. Red paint is used contrastingly to accent: arches and lintels; string courses; two story, monumental pilasters at the corners of the facades; and the water table, creating a visual base for the house.

8 SIGNIFICANCE

PERIOD	AREAS OF SIGNIFICANCE -- CHECK AND JUSTIFY BELOW			
<input type="checkbox"/> PREHISTORIC	<input type="checkbox"/> ARCHEOLOGY-PREHISTORIC	<input type="checkbox"/> COMMUNITY PLANNING	<input type="checkbox"/> LANDSCAPE ARCHITECTURE	<input type="checkbox"/> RELIGION
<input type="checkbox"/> 1400-1499	<input type="checkbox"/> ARCHEOLOGY-HISTORIC	<input type="checkbox"/> CONSERVATION	<input type="checkbox"/> LAW	<input type="checkbox"/> SCIENCE
<input type="checkbox"/> 1500-1599	<input type="checkbox"/> AGRICULTURE	<input type="checkbox"/> ECONOMICS	<input type="checkbox"/> LITERATURE	<input type="checkbox"/> SCULPTURE
<input type="checkbox"/> 1600-1699	<input checked="" type="checkbox"/> ARCHITECTURE	<input type="checkbox"/> EDUCATION	<input type="checkbox"/> MILITARY	<input type="checkbox"/> SOCIAL/HUMANITARIAN
<input type="checkbox"/> 1700-1799	<input type="checkbox"/> ART	<input type="checkbox"/> ENGINEERING	<input type="checkbox"/> MUSIC	<input type="checkbox"/> THEATER
<input checked="" type="checkbox"/> 1800-1899	<input type="checkbox"/> COMMERCE	<input type="checkbox"/> EXPLORATION/SETTLEMENT	<input type="checkbox"/> PHILOSOPHY	<input type="checkbox"/> TRANSPORTATION
<input type="checkbox"/> 1900-	<input type="checkbox"/> COMMUNICATIONS	<input type="checkbox"/> INDUSTRY	<input type="checkbox"/> POLITICS/GOVERNMENT	<input checked="" type="checkbox"/> OTHER (SPECIFY) Local History
		<input type="checkbox"/> INVENTION		

SPECIFIC DATES

BUILDER/ARCHITECT

STATEMENT OF SIGNIFICANCE

Located in the town of Newberry, South Carolina, Oakhurst was constructed between 1893 and 1895 by Budd Cade Matthews and Clara Crotwell Matthews. It is a combination of both Queen Anne and Italianate architecture and is also significant for its associations with locally prominent individuals.

Oakhurst or the Matthews House was constructed as a private residence by Budd Cade and Clara Crotwell Matthews. Mrs. Matthews was the daughter of James Alfred Crotwell, a prominent Newberry businessman who founded the Crotwell Brickyard. He was also involved in real estate and constructed one of the town's early hotels. Clara Belle Crotwell married Budd Cade Matthews on September 29, 1891. According to tradition, they lived in the Crotwell house on the present Oakhurst property following their marriage. It is believed that this frame house still stood on the site in 1893 when James Crotwell willed the property to his daughter. After James Crotwell's death on April 4, 1893, the older dwelling was demolished, and Oakhurst was constructed in its place. The house was certainly completed by 1895, as a photograph of Oakhurst dated that year reveals.

Budd Cade Matthews was a prominent Newberry banker, businessman and civic leader. Matthews founded the B.C. Matthews Brick Manufacturing Company and the Matthews and Cannon Mercantile Firm. He served as president of the National Bank of Newberry, as president of the Newberry Chamber of Commerce, and as a director of both the Newberry Cotton Mills and the Newberry Hospital Association. In addition, Budd Cade Matthews owned large farming interests.

Matthews and his wife lived at Oakhurst until their deaths. The house then passed to their son, William Enoch Matthews. His widow, Edith L. Matthews, continues to own Oakhurst.

9 MAJOR BIBLIOGRAPHICAL REFERENCES

Matthews Family Papers in possession of Mrs. Edith L. Matthews, Newberry, S.C.

Matthews, Mrs. Edith L.. Oakhurst, Newberry, South Carolina. Interview, 2 January 1979.

Obituary of James Alfred Crotwell. The Newberry Herald & News, 12 April 1893, p.3.

continued

10 GEOGRAPHICAL DATA

ACREAGE OF NOMINATED PROPERTY 2.1

UTM REFERENCES

A 17 445060 37193460
 ZONE EASTING NORTHING

B
 ZONE EASTING NORTHING

C

D

VERBAL BOUNDARY DESCRIPTION

Beginning just outside the highway right of way at the northwest corner of U.S. Highway 76 and S.C. Highway 219, thence northwest for 360 feet, thence leaving said right of way and turning southwest for 275 feet, thence turning south for 195 feet, thence turning east just outside the right of way of S.C. 219 for 370 feet to the point of origin.

LIST ALL STATES AND COUNTIES FOR PROPERTIES OVERLAPPING STATE OR COUNTY BOUNDARIES

STATE	CODE	COUNTY	CODE
-------	------	--------	------

STATE	CODE	COUNTY	CODE
-------	------	--------	------

11 FORM PREPARED BY

NAME / TITLE

(Nancy Fox, Central-Midlands Regional Planning Council)

Michele Barovsky, Historic Preservation Division

ORGANIZATION

DATE

South Carolina Department of Archives & History

January 17, 1979

STREET & NUMBER

TELEPHONE

P.O. Box 11,669, Capitol Station

(803) 758-5816

CITY OR TOWN

STATE

Columbia

South Carolina

12 STATE HISTORIC PRESERVATION OFFICER CERTIFICATION

THE EVALUATED SIGNIFICANCE OF THIS PROPERTY WITHIN THE STATE IS:

NATIONAL

STATE

LOCAL

As the designated State Historic Preservation Officer for the National Historic Preservation Act of 1966 (Public Law 89-665), I hereby nominate this property for inclusion in the National Register and certify that it has been evaluated according to the criteria and procedures set forth by the National Park Service.

STATE HISTORIC PRESERVATION OFFICER SIGNATURE

Charles E. Lee

TITLE Charles E. Lee
 State Historic Preservation Officer

DATE

2/9/79

FOR NPS USE ONLY

I HEREBY CERTIFY THAT THIS PROPERTY IS INCLUDED IN THE NATIONAL REGISTER

Charles E. Lee

DATE

4.24.79

DIRECTOR, OFFICE OF ARCHITECTURE AND HISTORIC PRESERVATION

KEEPER OF THE NATIONAL REGISTER

ATTEST: *Bill Bowick*

DATE

April 24, 1979

KEEPER OF THE NATIONAL REGISTER

UNITED STATES DEPARTMENT OF THE INTERIOR
NATIONAL PARK SERVICE

**NATIONAL REGISTER OF HISTORIC PLACES
INVENTORY -- NOMINATION FORM**

FOR NPS USE ONLY

RECEIVED
FEB 26 1979
DATE ENTERED

APR 24 1979

CONTINUATION SHEET

ITEM NUMBER 7

PAGE 1

Interior: The present eleven room house with a central hall and flanking rooms on each floor differs little from the original plan, which featured ten rooms and a right rear kitchen connected to the main block by a latticed and screened breezeway. Of particular note is the access to the exterior from three of the upstairs chambers provided by the balcony on the right facade and by the roof of the porte cochere on the left facade. The only alterations to the original form consist of the enclosure in 1945 of the kitchen passageway and of the adjoining open porch. The original cypress shingle roof was replaced in December, 1978 with modern composition shingles because of deterioration; however, the original structural members were retained.

The interior of the house retains original fabric throughout, including center beaded wainscoting in the two rear first floor rooms and in the first floor and second floor halls. Of particular note is the main stair hall, which reflects the influence of the Arts & Crafts Movement in its grouping of fireplace, spool and spindle screen separating the staircase from the rest of the space, built-in bench, panelled staircase wall, and in the turn of the balustraded staircase itself.

Other significant interior features include: the spool and spindle frieze decorating the turret alcove of the right front room; ten fireplaces, each with beveled glass overmantel, differently carved Victorian mantel and overmantel and differently tiled architrave; original inside wooden shutters at each double-hung window, still functioning; single-paned transom above each interior door; and, a downstairs intercom system.

Surroundings: Oakhurst is located in an urban setting and is surrounded by a modern brick serpentine fence. Located within this fence and included within the nominated acreage are several notable outbuildings which were also constructed during the 1890s. Still extant to the rear of the house are a small brick milk house, a rectangular frame wood/hen house, a frame stable and a double brick privy. Also located behind the house is a frame kitchen set on a raised brick basement, which belonged to the earlier Crowell dwelling on the property. To the left of the house, indicated by brick foundations, are the sites of a greenhouse and a windmill. The latter powered the original system for inside faucets in conjunction with the well, which is still standing nearby. Although the Oakhurst property itself is unaltered, there is commercial development located adjacent to the property.

FOR HCRS USE ONLY	
RECEIVED	
DATE ENTERED	FEB 26 1979 24

NATIONAL REGISTER OF HISTORIC PLACES INVENTORY -- NOMINATION FORM

CONTINUATION SHEET

ITEM NUMBER 8

PAGE 1

Architecture: Oakhurst is an excellent example of both the Queen Anne and Italianate styles as combined in a single residential structure. It was designed by the architectural firm of La Motte and Niernsee, according to the original plans in the possession of the present owner. Niernsee was one of the architects of the South Carolina Statehouse (National Historic Landmark). Oakhurst is the only house in Newberry known to have been designed by the Niernsee firm and is the only identified brick dwelling in the Central Midlands Region of the state which features the Queen Anne style. The house has remained in the ownership of the Matthews family since its construction and has retained much of its original character. Through the years the owners have also continued to maintain the historic cream and red paint of the exterior. Among the outstanding architectural features of the house are its turret, encircling veranda, arched entryway and stair hall.

Also a notable part of the Oakhurst property are the original dependencies. These include a brick privy, brick milk house, frame stable, combination wood and hen house and well.

UNITED STATES DEPARTMENT OF THE INTERIOR
NATIONAL PARK SERVICE

**NATIONAL REGISTER OF HISTORIC PLACES
INVENTORY -- NOMINATION FORM**

FOR NPS USE ONLY	
RECEIVED	FEB 26 1978
DATE ENTERED	APR 24 1979

CONTINUATION SHEET

ITEM NUMBER 9 PAGE 1

"Old Newberry Hotel of Many Names Now Modernized and Still Serving."
The Columbia Record, 12 December 1946, Sec. D, p.5.

Probate Records of Newberry County, Will Book 4, pp.278-282.
Newberry County Clerk of Court, Newberry County, S.C.

South Carolina. Chicago and New York: The Lewis Publishing Company, 1920, p.77.

Summer, George Leland. Newberry County South Carolina Historical and
Genealogical. Newberry County, S.C.: By the Author, 1950, p.42

Who's Who in the South. Washington, D.C.: The Mayflower Publishing Company,
1927, p. 476.

"Oakhurst"
Newberry, S.C.

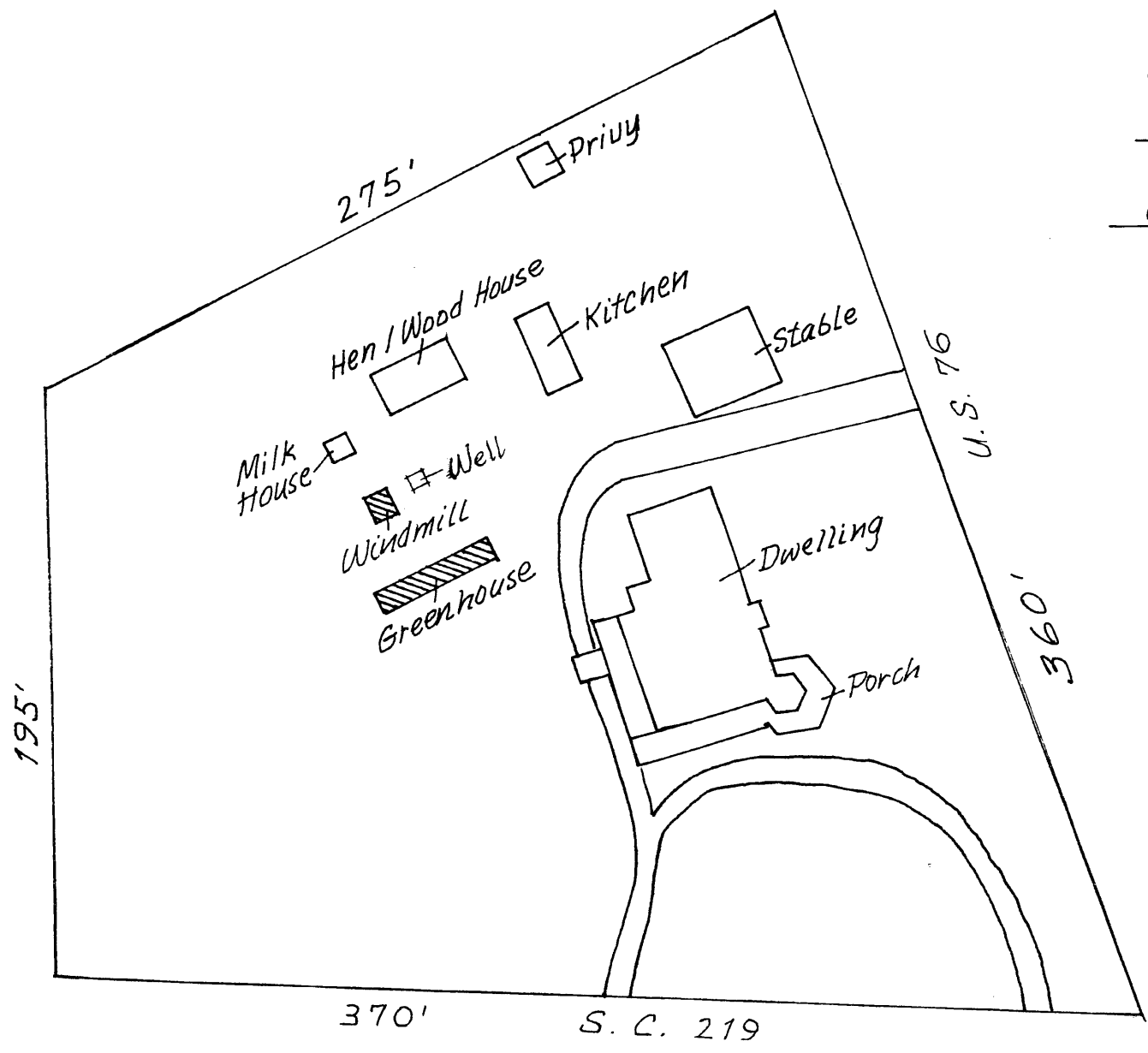

1" = 50'
▨ Sites
Approximately 2.1 Acres

